

BAUER CAREER FAIR 9.16.16

**UH HILTON • 12 - 4 P.M.
REGISTER AT HIREBAUER.COM**

Open to all Bauer majors
Professional dress required

UNIVERSITY of HOUSTON | BAUER
Rockwell Career Center

University of Houston C. T. Bauer College of Business Career Fair

9/16/2016

Conrad, Waldorf and Shamrock Ballrooms

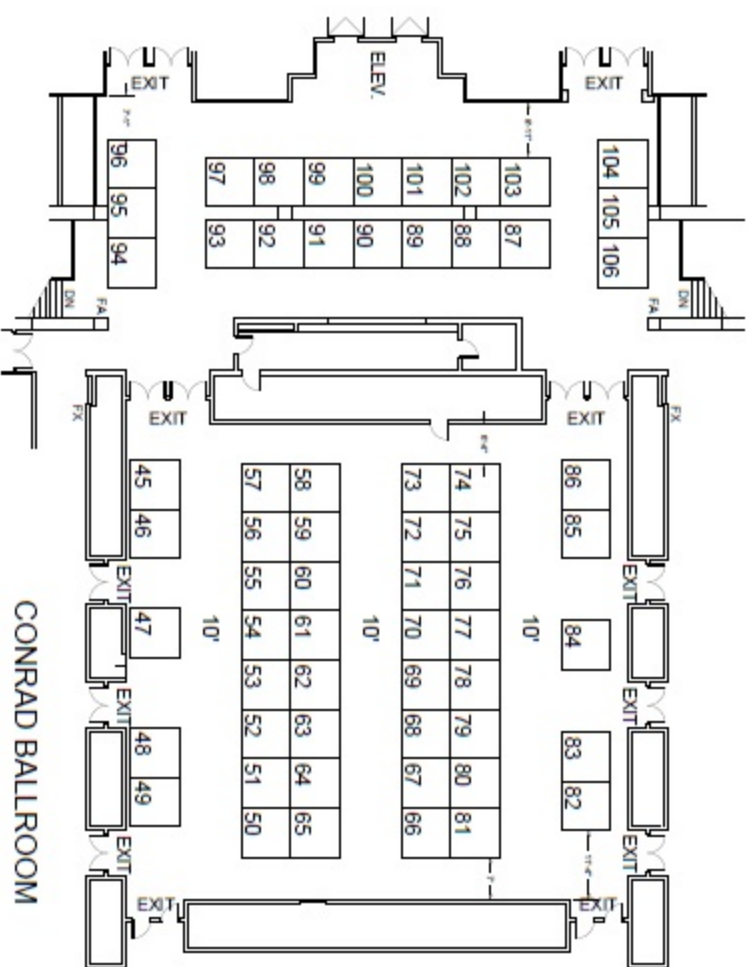

CONRAD BALLROOM

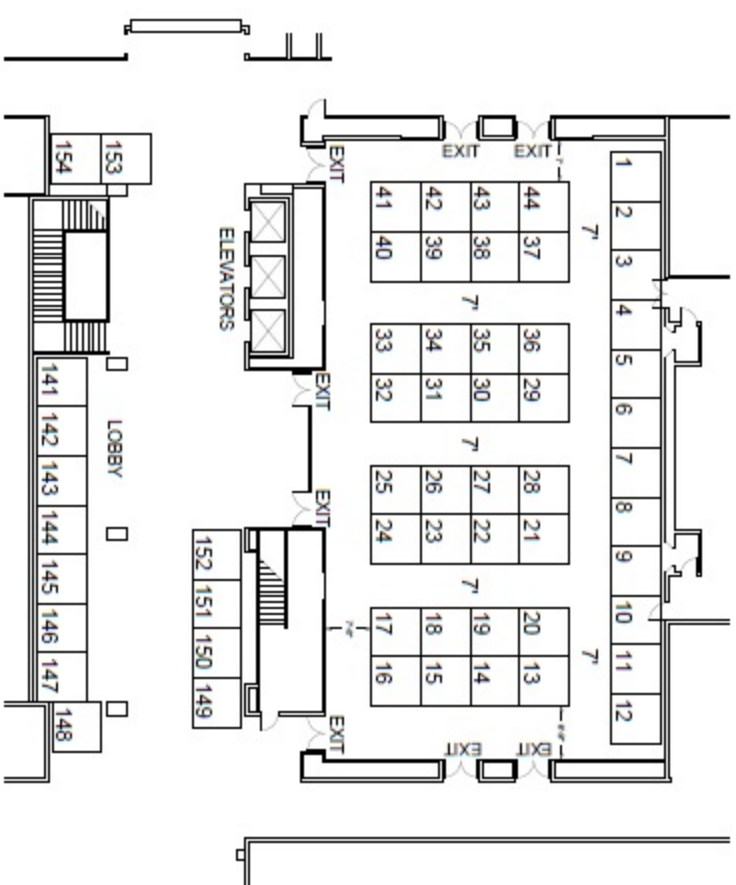

WALDORF BALLROOM

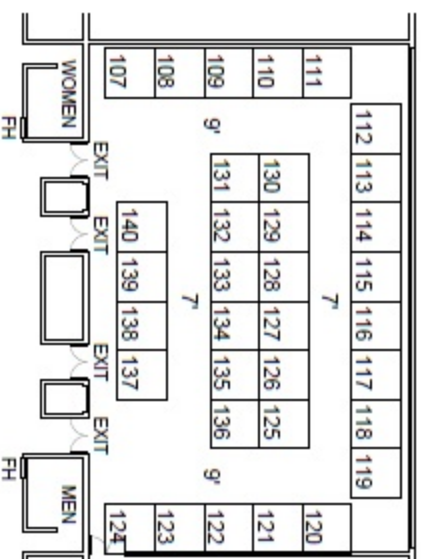

SHAMROCK BALLROOM

Booth #	Employer	BBA	MBA/EMBA, MS	MS ACCY	ACCT	ENTR	FINA	MGMT	MKGT	MIS	SCM
12	Academy Sport & Outdoors	X							X	X	X
70	Admiral by AlSCO, Inc	X			X	X	X	X	X	X	X
50	Air Liquide	X			X		X				
143	Aldi	X			X		X	X	X		X
46	alliantgroup, LP										
84	Amazon	X			X	X	X	X	X	X	X
75	Amegy Bank	X			X		X				
19	American Century Investments	X			X	X	X	X	X	X	X
135	Anadarko Petroleum Corporation	X	X		X	X	X	X	X		
136	Anadarko Petroleum Corporation	X	X						X	X	
5	Andersen Tax, LLC	X	X	X	X						
23	Aon	X			X	X	X	X	X	X	X
131	Apple Inc.	X	X	X	X	X	X	X	X	X	X
43	ARAMARK	X			X	X	X	X	X	X	X
129	Argus Media		X		X	X	X	X	X	X	X
130	AXA Advisors NYC	X	X	X	X	X	X	X	X	X	X
80	Bamberger Polymers, Inc		X		X	X	X	X	X	X	X
150	Bauer College of Business - MBA	X			X	X	X	X	X	X	X
148	Bauer in DC	X			X	X	X	X	X	X	X
21	BDO	X		X	X						
39	BKD	X		X	X						
112	BP Corporation	X			X	X	X	X	X	X	X
134	Branch Banking and Trust Company (BB&T)	X	X	X	X	X	X	X	X	X	X
8	Cabela's Inc.	X	X	X	X	X	X	X	X	X	X
141	Cadence Bank	X			X	X	X	X	X	X	X
64	California Franchise Tax Board	X		X	X						
133	Calpine Corporation	X	X	X	X		X	X			
85	Capgemini Consulting North America	X			X	X	X	X	X	X	X
31	Capital One Bank	X			X	X	X	X	X	X	X
108	CenterPoint Energy	X			X		X				
99	CH Robinson	X				X			X		X
37-38	Cheniere Energy, Inc.	X			X		X			X	X
123-124	Chevron	X			X	X	X	X	X	X	X
24	ChevronPhillips Chemical Company	X		X	X			X	X	X	X
61	CNA Insurance	X				X	X	X	X		
15-16	ConocoPhillips	X			X		X				
58	Consumer Financial Protection Bureau	X	X	X	X	X	X	X	X	X	X
77	Cybersoft PrimeroEdge	X	X	X	X	X	X	X	X	X	X
47	Deloitte	X		X	X					X	
79	Duff & Phelps	X	X	X	X		X				
17-18	Ecolab, Inc.	X			X	X	X	X	X		
53	Edward Jones	X	X	X	X	X	X	X	X	X	X
32	Enterprise Holdings	X			X	X	X	X	X	X	X
33	Enterprise Products	X	X	X	X						
94-96	ExxonMobil	X		X	X		X			X	

Booth #	Employer	BBA	MBA/EMBA, MS	MS ACCY	ACCT	ENTR	FINA	MGMT	MKGT	MIS	SCM
115	Fastenal	X			X	X	X	X	X	X	X
106	Federal Reserve Bank	X			X		X	X	X	X	
113	Fidelity Investments	X			X	X	X	X	X	X	X
117	FMC Technologies	X	X	X	X		X				X
126	Foresters Financial	X			X	X	X	X	X	X	X
152	Geico	X	X		X	X	X	X	X	X	X
34	Goosehead Insurance	X	X		X	X	X	X	X	X	X
60	Grimco, Inc.	X						X	X		X
36	H-E-B	X	X		X	X	X	X	X	X	X
1	Halliburton	X					X	X	X	X	
45	Hewlett Packard Enterprise	X	X	X	X	X	X	X	X	X	X
127	Houston Apartment Association	X	X	X	X	X	X	X	X	X	X
86	HP Inc.	X	X	X	X		X				
13	IMG Financial Group, Inc.										
116	Inceed	X	X	X	X	X	X	X	X	X	X
114	IPFC Corp.	X	X	X	X		X				
97	JCPenney	X	X	X	X	X	X	X	X	X	X
73	Kellogg Company	X						X	X		
111	KPMG	X	X	X	X		X			X	
101	Landry's Inc.	X	X	X	X	X	X	X	X	X	X
71	Levi, Ray & Shoup, Inc.	X	X			X		X	X		
28	Liberty Mutual Insurance	X				X		X	X		
98	Lionstone Investments	X	X				X				
56-57	LyondellBasell	X	X							X	X
14	MaloneBailey, LLP	X		X	X						
110	Marketch Corp.	X			X	X	X	X	X	X	X
81	Marsh and McLennan Companies (MMC)	X			X	X	X	X	X	X	X
107	Martin Brower	X	X					X			X
40	Mattress Firm	X			X	X	X	X	X	X	X
2	McConnell & Jones LLP	X	X	X	X		X	X	X		
78	MDT Financial Advisors, LLC	X			X	X	X	X	X		
125	Mitsubishi Caterpillar Forklift America	X	X	X	X	X	X	X	X	X	X
109	Modern Woodmen Fraternal Financial	X	X	X	X	X	X	X	X	X	X
151	Mondelez International	X	X	X	X	X	X	X	X	X	X
118	Nino & Associates, Inc.	X			X	X	X	X	X	X	X
22	Noble Energy	X	X	X	X		X				
42	Northwestern Mutual	X	X	X	X	X	X	X	X	X	X
10	NRG Energy	X	X	X	X	X	X	X	X	X	X
68	Nuture Meals	X	X	X	X	X	X	X	X	X	X
55	Occidental Petroleum Corporation	X		X	X		X			X	
122	Office of the Comptroller of the Currency	X			X		X				
27	OneMain Financial	X			X		X	X	X		
65	OpenLink Financial	X	X							X	
147	Opportune LLP	X		X	X		X			X	X
146	PetSmart	X									X
6-7	Phillips 66	X		X	X		X			X	

Booth #	Employer	BBA	MBA/EMBA, MS	MS ACCY	ACCT	ENTR	FINA	MGMT	MKGT	MIS	SCM
35	PROS	X	X		X	X	X	X	X	X	X
104	Prudential Financial	X	X	X	X	X	X	X	X	X	X
51	Quest IRA Inc.	X	X	X	X	X	X	X	X	X	X
103	Ross Stores, Inc.	X			X	X	X	X	X	X	X
48	RSM US LLP	X		X	X						
69	S&P Global	X	X	X	X		X	X			
142	San Jacinto College	X	X	X	X			X	X	X	X
4	SAS	X	X		X		X			X	
49	Schlumberger	X	X	X	X		X				X
29	Sewell Automotive Companies	X	X	X	X	X	X	X	X	X	X
82-83	Shell Oil	X			X		X		X	X	X
128	Shilson Goldberg Cheung & Associates LLP	X		X	X	X	X	X	X	X	X
26	Southeastern Freight Lines	X	X	X				X			X
52	Southern Company/Sequent Energy Management	X	X		X		X				
66	Southwestern Energy	X		X	X						
100	Spectra Energy	X		X	X					X	X
41	Stage	X						X	X		
63	Statoil	X	X	X	X	X	X	X	X	X	X
3	Stout Risius Ross	X			X		X				
121	Tange, Mann & Garza	X	X		X						
72	Targa Resources	X	X		X		X			X	X
149	Target Stores	X	X	X	X	X	X	X	X	X	X
25	TDECU	X	X	X	X	X	X	X	X	X	X
11	The Claro Group	X	X	X	X		X	X			
59	The Friedkin Group	X	X	X	X		X		X	X	
76	The Hershey Company	X							X		X
119	The Reynolds and Reynolds Company	X	X	X	X	X	X	X	X	X	X
20	The Sherwin-Williams Company	X			X	X	X	X	X	X	X
144	The Travelers Companies, Inc.	X			X	X	X	X	X	X	X
132	Tokio Marine HCC	X	X	X	X	X	X	X	X	X	X
105	Uline	X			X	X	X	X	X	X	X
62	Universal American Mortgage Company	X			X	X	X	X	X	X	X
145	UPS	X			X	X	X	X	X	X	X
102	USAA	X			X	X	X	X	X	X	X
120	Walgreens	X			X	X	X	X	X	X	X
54	Walmart DC 7042	X	X								X
44	Wealth Development Strategies, L.P.	X				X	X	X	X		
30	Williams Companies	X	X	X	X		X			X	
67	Wisnibaker Builder Services	X	X	X	X	X	X	X	X	X	X
9	WUNDERMAN	X				X		X	X	X	X
74	Yelp	X				X	X	X	X		

UNIVERSITY of HOUSTON | BAUER
Rockwell Career Center

The Rockwell Career Center would like to thank the members of our Corporate Advisory Board for all of their support and guidance in the past year:

INTERVIEW ROOM SPONSORS

Chevron
Enterprise Rent-A-Car
Reynolds & Reynolds
TDECU

GOLD PARTNERS

Halliburton
Shell Oil

SILVER PARTNERS

Chevron Phillips
ConocoPhillips
Target Stores
Phillips 66

BRONZE PARTNERS

Bechtel
BP
Direct Energy
Enterprise Products Partners LP
ExxonMobil
GEICO
PLS Logistics Services
Sunoco
RSM US LLP